

Specifications — AVTrac™ 4C/4R Extension Kits

General

- Mounting options..... Mountable onto base flooring, beneath finished carpeting
- Enclosure type Metal track base and top, plastic ramps
- Enclosure dimensions: see diagrams below
- Side ramps..... 0.67" (1.7 cm) H x 7.50" (19.0 cm) W on either side of track x 48.0" (121.9 cm) L, approximately 4.5° slope
- AVTrac 4C EXT track base and top 1.03" H x 3.70" W x 48.0" L
(2.6 cm H x 9.4 cm W x 121.9 cm L)
- AVTrac 4R EXT track base and top 0.95" H x 3.70" W x 48.0" L
(2.4 cm H x 9.4 cm W x 121.9 cm L)

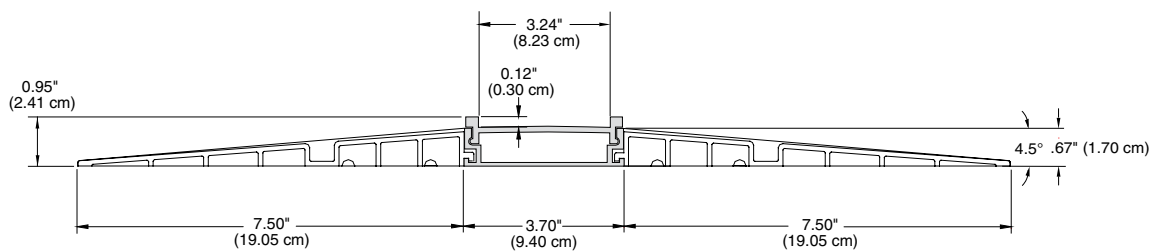
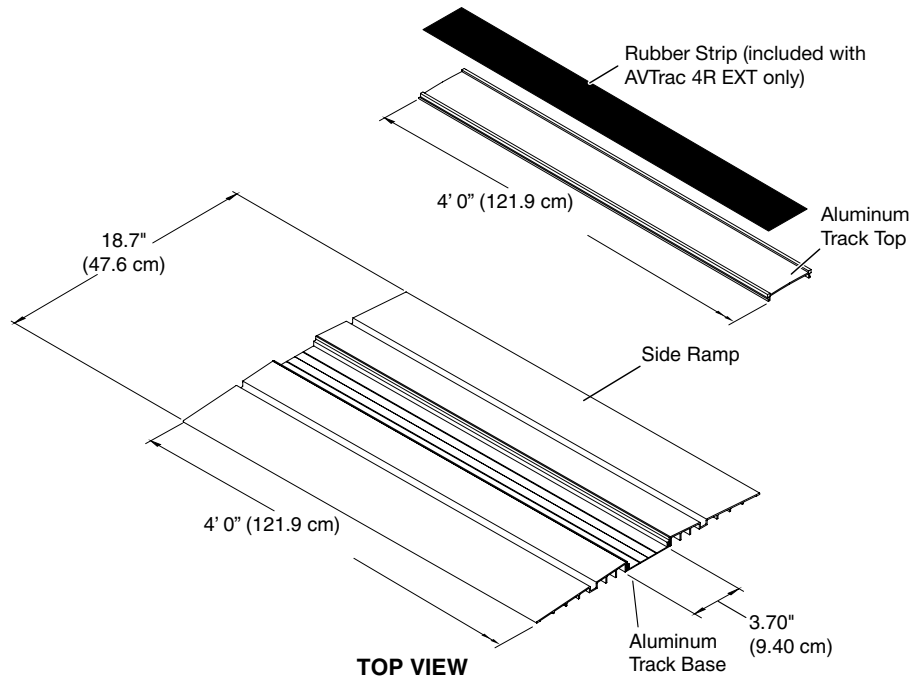

BACK VIEW of AVTrac 4R EXT

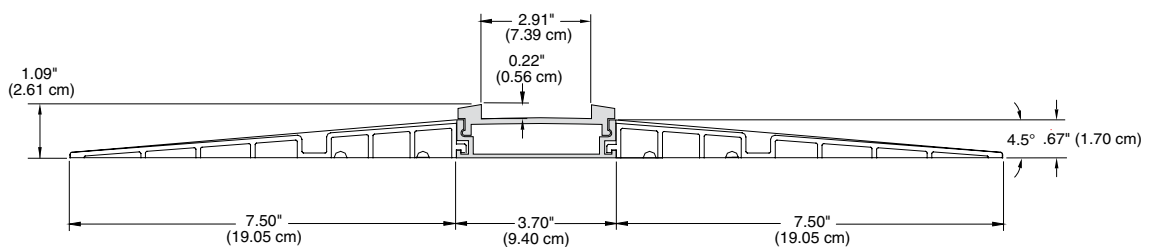

BACK VIEW of AVTrac 4C EXT

Specifications — AVTrac™ 4C/4R Extension Kits, cont'd

Product weight	8.9 lbs (4.0 kg)
Shipping weight	11 lbs (5 kg)
Vibration	ISTA 1A in carton (International Safe Transit Association)
Regulatory compliance	
Accessibility	Title III, Regulation 28 CFR Part 36: ADA Standards for Accessible Design; Section 4.8: Ramps
Warranty	3 years parts and labor

NOTE *Specifications are subject to change without notice.*

7.6-091008-D5